

Write with advice

13<sup>th</sup> August 2006

Postal Address: [Redacted]



Form Address (no post). [Redacted]

To L.I.C.C.  
Minerals plan

Dear Mr Urban,

We phoned you last week for advice on how to enter our land into the minerals plan,

I enclose a map of the farm with the latest Rural Land Register field numbers.

I have overlaid the farm map with the area bounded in red which would be most suitable for gravel extraction, and I have indicated in orange, access roads.

I also include a forest commission ash tree plantation and uses for the remaining area of farm which could continue.

The gravel could be extracted and taken by road to the pit at Hemmington or an possibility is by rail from the nearby Sidings.

We could retain ownership of the land and return it to natural ponds and fields with a few cattle and a horse riding activity.

Please reply with advice on the next step and planning procedure with the cost if known

Yours sincerely

D.F. Osborne.

13<sup>th</sup> AUGUST 2006  
01332 810667

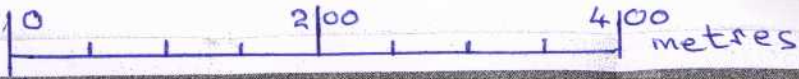

LAND AT TRENT FARM  
BACK LANE, CASTLE DONINGTON  
PROPOSED 12 HECTARES  
GRAVEL QUARRIES

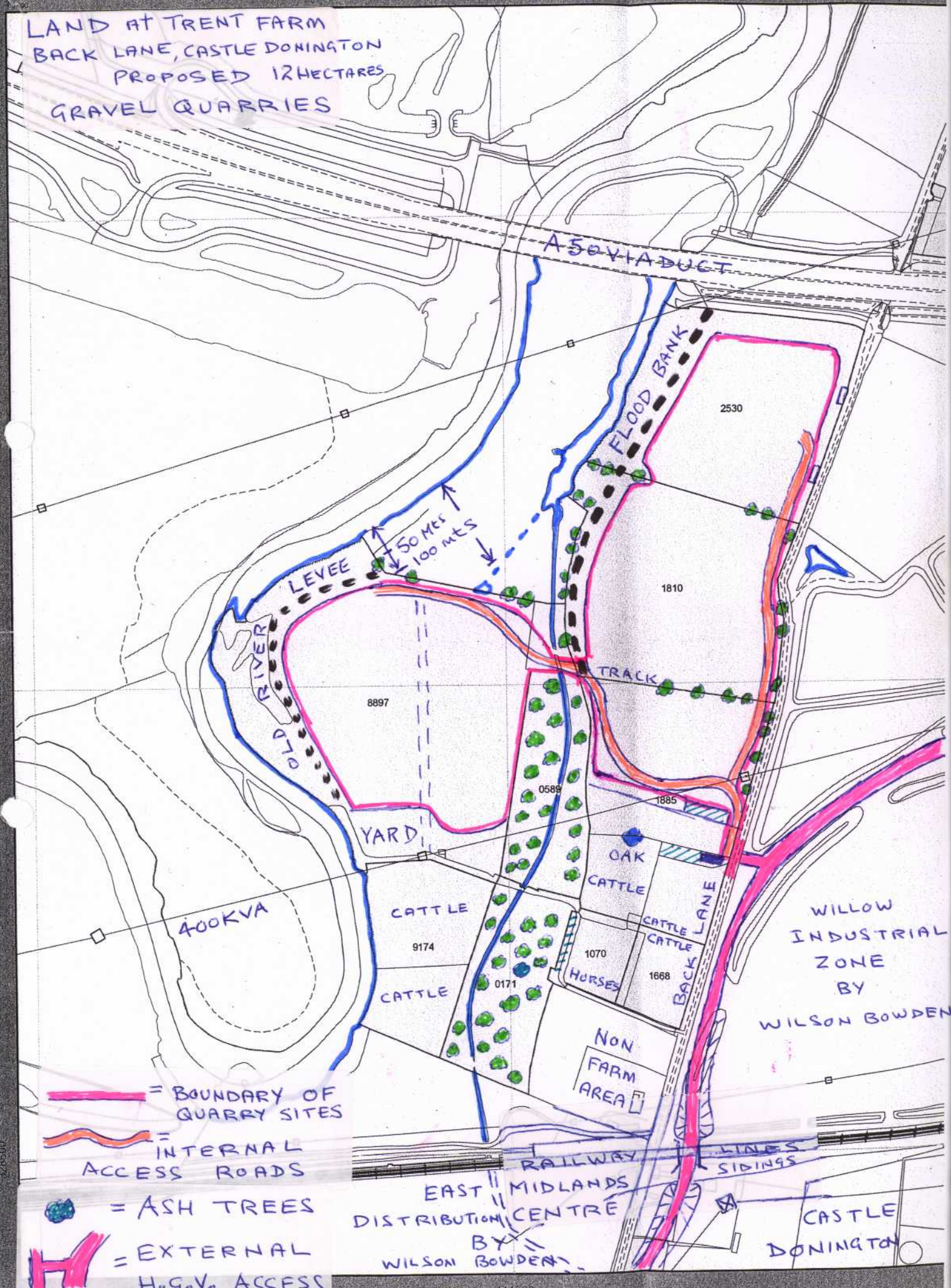

- = BOUNDARY OF QUARRY SITES
- = INTERNAL ACCESS ROADS
- = ASH TREES
- = EXTERNAL H.O.G.V.O ACCESS